

# Series DPS/DPSH

## Digital Push/Pull Force Gauges with Outputs



**Optional Handle OH-1**  
Fits DPS gauges to facilitate the measurement of heavy loads.

- Best value digital force gauge with capacity up to 1100 lbs (push/pull)
- RS-232C, Digimatic and analog outputs
- Overload capacity 200% F.S.
- Ergonomic, heavy-duty metal construction
- lb, kg, and Newton units are push-button selectable
- Overload alarm, low battery display indicator
- Outstanding display update of 20 times/second
- Runs on internal NiCad batteries or AC adapter
- Real time and peak mode (selectable)
- Tare function
- Full set of accessories, AC charger/adapter and carrying case



All DPS/DPSH gauges are sold in kit form.

### DPS/DPSH Specifications

<b>Accuracy</b>	±0.2% ±1 LSD
<b>Selectable Units</b>	Pounds, Kilograms or Newtons
<b>Overload Capacity</b>	200% of F.S. Display flashes beyond 105% of F.S.
<b>Display Update</b>	20 times/second
<b>Power</b>	Rechargeable NiCad battery pack or AC adapter
<b>Low Battery Indicator</b>	Display flashes BAT when battery is low
<b>CPU</b>	8-bit C-MOS
<b>Outputs</b>	RS-232, Mitutoyo Digimatic and ±1 VDC analog output
<b>Operating Temp.</b>	32° to 100°F (0° to 40°C)

DPS/DPSH digital force gauges represent the latest technology in affordable, feature packed instruments. The rugged metal housings are ergonomically designed, yet durable enough to withstand harsh industrial environments.

The easy to read displays tell you at a glance the unit of measurement (lb, kg, or Newtons), tension or compression, Peak Mode, and whether the built-in NiCad batteries are low. The standard outputs (RS-232C, Digimatic, and ±1VDC analog) allow you to capture data for permanent record.

### DPS Ranges (Resolution) Accuracy: ±0.2% F.S. ±1 LSD

Model	Capacity (Resolution)		
	Pounds (Ounces)	Kilograms (Grams)	Newtons
DPS-0.5	8.819 oz (0.01 oz)	250.0 g (0.1 g)	2.452 N (0.001 N)
DPS-1	17.64 oz (0.01 oz)	500.0 g (0.1 g)	4.903 N (0.001 N)
DPS-4	4.409 lb (0.001 lb)	2.000 kg (0.001 kg)	19.61 N (0.01 N)
DPS-11	11.02 lb (0.01 lb)	5.000 kg (0.001 kg)	49.03 N (0.01 N)
DPS-44	44.09 lb (0.01 lb)	20.00 kg (0.01 kg)	196.1 N (0.1 N)
DPS-110	110.2 lb (0.1 lb)	50.00 kg (0.01 kg)	490.3 N (0.1 N)
DPS-220	220.5 lb (0.1 lb)	100.0 kg (0.1 kg)	980.6N (0.1 N)

Choose the range or ranges that best suit your needs. All DPS/DPSH gauges are sold complete in kit form with gauge, hard plastic carrying case, full set of measuring adapters, extension rod, and AC adapter/charger. All DPS/DPSH gauges can be run on the internal NiCad batteries or the AC adapter/charger.

### DPSH Ranges (Resolution) Accuracy: ±0.2% F.S. ±1 LSD

Model	Capacity (Resolution)		
	Pounds	Kilograms	Newtons
DPSH-440	441.0 lb (0.1 lb)	200.0 kg (0.1 kg)	1960 N (1 N)
DPSH-1100	1102 lb (1 lb)	500.0 kg (0.1 kg)	4900 N (1 N)

Note: Use an "R" suffix for reverse display units (for use on vertical test stand)  
Specifications subject to change without notice.



DPSH includes handle

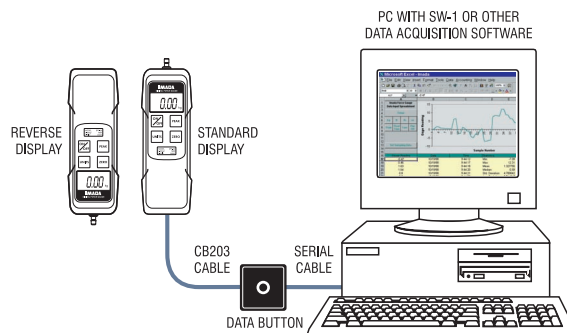

### SW-1 Data Acquisition Software (optional)

Capture and analyze real-time data from any Imada gauge with an RS-232 port directly into any Windows program. Log and chart measurements as well as statistical information. Control the gauge from your computer.

### DB-1 Data Input Button (optional)

DB-1 is a simple, compact, one channel interface that enables the user to send measurement data to a PC running SW-1, Imada data acquisition software or other software. The data input button simplifies peak measuring tests because it 'zeros' the gauge after sending the data to the computer eliminating the need to reset manually for each test.